

Thank you for choosing Black & Decker! To register your new product, go to [www.BlackandDecker.com/NewOwner](http://www.BlackandDecker.com/NewOwner).

**PLEASE READ BEFORE RETURNING THIS PRODUCT FOR ANY REASON.**

If you have a question or experience a problem with your Black & Decker purchase, go to <http://www.blackanddecker.com/instantanswers>. If you can't find the answer or do not have access to the Internet, call 1-800-544-6986 from 8 a.m. to 5 p.m. EST Mon. - Fri. to speak with an agent. Please have the catalog number available when you call.

**SAVE THIS MANUAL FOR FUTURE REFERENCE.**

VEA EL ESPAÑOL EN LA CONTRAPORTADA.

INSTRUCTIVO DE OPERACIÓN, CENTROS DE SERVICIO Y PÓLIZA DE GARANTÍA.

⚠ **ADVERTENCIA: LÉASE ESTE INSTRUCTIVO ANTES DE USAR EL PRODUCTO.**

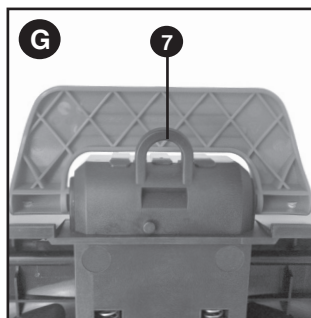
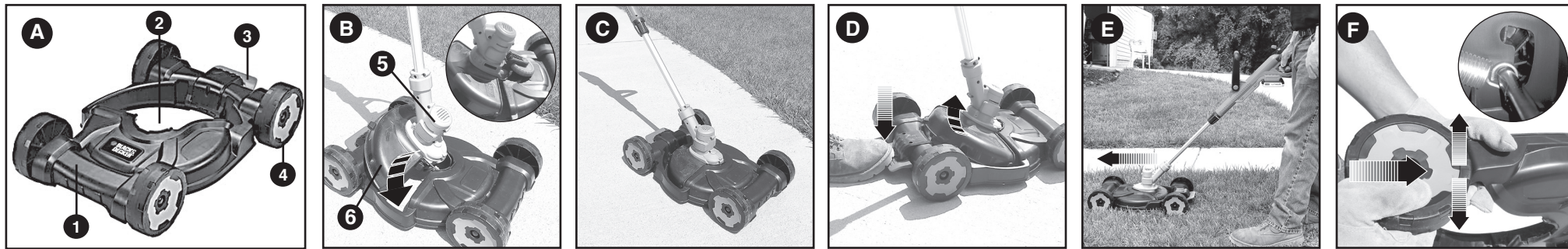

### SAFETY GUIDELINES - DEFINITIONS

It is important for you to read and understand this manual. The information it contains relates to protecting YOUR SAFETY and PREVENTING PROBLEMS. The symbols below are used to help you recognize this information.

⚠ **DANGER:** Indicates an imminently hazardous situation which, if not avoided, will result in death or serious injury.

⚠ **WARNING:** Indicates a potentially hazardous situation which, if not avoided, could result in death or serious injury.

⚠ **CAUTION:** Indicates a potentially hazardous situation which, if not avoided, may result in minor or moderate injury.

**NOTICE:** Used without the safety alert symbol indicates potentially hazardous situation which, if not avoided, may result in property damage.

### -SAVE THESE INSTRUCTIONS- READ ALL INSTRUCTIONS

#### FUNCTIONAL DESCRIPTION (FIGURE A)

1. Mower Deck 2. Trimmer Pocket 3. Release lever 4. Adjustable Wheels

The 3-in-1 compact mower deck works with the following Black and Decker string trimmers: **GH912, LST220, LST300, LST400, LST420, NST2118**

⚠ **WARNING:** Read and understand the string trimmer manual, as well as this mower deck manual, before using this mower deck. Failure to do so may result in personal injury or property damage.

⚠ **WARNING:** The use of any tool not recommended by Black & Decker for use with this accessory could be hazardous.

⚠ **WARNING:** Mower deck and string trimmer are not toys. Use as such may result in personal injury or property damage.

⚠ **CAUTION:** Inspect area to be trimmed and remove any stones, sticks, wire, cord, or string-like objects which could become entangled in the rotating line or spool. Release switch and allow the trimmer to stop before crossing walk, roads, patio and gravel drives.

#### ASSEMBLY

⚠ **WARNING:** Before attempting any of the assembly or disassembly steps below, ensure your string trimmer is switched off and disconnected from the power supply.

⚠ **CAUTION:** Refer to your string trimmer manual prior to using trimmer in conjunction with the mower deck.

To attach a string trimmer to the mower deck (1):

- Slide the bottom of the string trimmer head (5) into the front of the trimmer pocket (2) and rotate the trimmer guard (6) down into the pocket until it snaps fully into place as shown in **figure B and C**. If string trimmer has a wire edge guide, the guide should be below the deck. If string trimmer has a wheeled edge guide, the guide should be above the deck as shown in the **Figure B insert**.

**NOTE:** Ensure the cutting line is underneath the deck and not protruding out the top.

- Using the string trimmer auxiliary and back handles, lift up the string trimmer and ensure the mower deck is securely attached.
- The trimmer should be in the position shown in **figure C**.
- To remove the string trimmer from the mower deck, step on the release lever (3) and lift the trimmer out as shown in **figure D**.

⚠ **CAUTION:** Depending on the string trimmer and/or battery pack used with the mower deck, the assembly may become unbalanced and tip. Care should be exercised when using on uneven ground or a slope. String trimmer should be removed from mower deck when storing or when user leaves its vicinity.

#### OPERATING INSTRUCTIONS

- Once a string trimmer is attached to the mower deck, switch trimmer on as directed by your trimmer's instruction manual.
- Grip the handle of the string trimmer and move the mower deck forward slowly in a straight line to ensure even cutting and coverage of the lawn as shown in **figure E**. Do not lift up or pivot mower deck. Keep all four wheels in contact with the ground.

**NOTE:** The deck can either be moved in long lines in a traditional mowing fashion or moved back and forth in a vacuuming-like motion.

**NOTE:** Several passes may be required with long grass.

#### WHEEL ADJUSTMENT

⚠ **WARNING:** Before adjusting the height of the mower deck, ensure your string trimmer is switched off and disconnected from the power supply.

The 3-in-1 compact mower deck offers two cutting lengths; 1.5" (40mm) and 2.3" (60mm).

To adjust the height of the mower deck:

- Grasp the wheel (4) of the mower deck and push it toward the front of the deck as shown in **figure F**.
- Then, slide the wheel up or down within the U-shaped groove (**figure F insert**) under the deck to set the height. Move the wheel up for shorter-cut grass or down for a longer-cut.
- Repeat for each wheel until all four wheels are adjusted to the same height and are fully in the upper or lower slots.

**NOTE:** If wheels are not located at the same height, it will result in an uneven cut.

**NOTE:** It may be simpler to adjust the height of your mower deck if the string trimmer is not attached.

#### STORAGE

Your mower deck can be hung on a wall for easy storage (**figure G**).

- Secure a nail or screw in a wall at your desired location.
- Hang the mower deck on the nail or screw by the hook (7) located under the release lever (3).

#### MAINTENANCE

⚠ **WARNING:** Remove line trimmer from mower deck before performing any maintenance.

- Plastic parts may be cleaned by using a mild soap and a damp rag. Do not pour or spray water on the mower deck or trimmer in an attempt to clean them.
- Do not lubricate the wheels.
- Clean away built-up dirt and grass in trimmer pocket (2) and under release lever (3) to allow trimmer to attach correctly.

#### SERVICE INFORMATION

All Black & Decker Service Centers are staffed with trained personnel to provide customers with efficient and reliable service. Whether you need technical advice, repair, or genuine factory replacement parts, contact the Black & Decker location nearest you. To find your local service location, call: **1-800-544-6986** or visit [www.blackanddecker.com](http://www.blackanddecker.com)

#### FULL TWO-YEAR HOME USE WARRANTY

Black & Decker (U.S.) Inc. warrants this product for two years against any defects in material or workmanship. The defective product will be replaced or repaired at no charge in either of two ways. The first, which will result in exchanges only, is to return the product to the retailer from whom it was purchased (provided that the store is a participating retailer). Returns should be made within the time period of the retailer's policy for exchanges (usually 30 to 90 days after the sale). Proof of purchase may be required. Please check with the retailer for their specific return policy regarding returns that are beyond the time set for exchanges. The second option is to take or send the product (prepaid) to a Black & Decker owned or authorized Service Center for repair or replacement at our option. Proof of purchase may be required. This warranty does not apply to accessories. This warranty gives you specific legal rights and you may have other rights which vary from state to state or province to province. Should you have any questions, contact the manager of your nearest Black & Decker Service Center. This product is not intended for commercial use.

**FREE WARNING LABEL REPLACEMENT:** If your warning labels become illegible or are missing, call **1-800-544-6986** for a free replacement.

**LATIN AMERICA:** This warranty does not apply to products sold in Latin America. For products sold in Latin America, check country specific warranty information contained in the packaging, call the local company or see the website for warranty information.

Imported by  
Black & Decker (U.S.) Inc.,  
701 E. Joppa Rd.  
Towson, MD 21286 U.S.A.



### LIGNES DIRECTRICES EN MATIÈRE DE SÉCURITÉ - DÉFINITIONS

Il est important que vous lisiez et compreniez ce mode d'emploi. Les informations qu'il contient concernent VOTRE SÉCURITÉ et visent à ÉVITER TOUT PROBLÈME. Les symboles ci-dessous servent à vous aider à reconnaître cette information.

⚠ **DANGER :** Indique une situation dangereuse imminente qui, si elle n'est pas évitée, causera la mort ou des graves blessures.

⚠ **AVERTISSEMENT :** Indique une situation potentiellement dangereuse qui, si elle n'est pas évitée, pourrait causer la mort ou de graves blessures.

⚠ **MISE EN GARDE :** Indique une situation potentiellement dangereuse qui, si elle n'est pas évitée, pourrait causer des blessures mineures ou modérées.

**AVIS :** Utilisé sans le symbole d'alerte à la sécurité, indique une situation potentiellement dangereuse qui, si elle n'est pas évitée, peut résulter en des dommages à la propriété.

#### DESCRIPTION FONCTIONNELLE (FIGURE A)

1. Châssis de tondeuse 2. Poche du taille-bordure  
3. Levier de dégagement 4. Roues réglables

Le châssis de tondeuse compact 3 en 1 fonctionne avec les taille-bordures à fil rotatif Black and Decker suivants :

**GH912, LST220, LST300, LST400, LST420, NST2118**

⚠ **AVERTISSEMENT :** Lire et comprendre le manuel du taille-bordures, ainsi que ce manuel de châssis de tondeuse, avant d'utiliser ce châssis de tondeuse. Négliger de le faire risque de causer des blessures à des personnes ou d'endommager des biens matériels.

⚠ **AVERTISSEMENT :** L'utilisation de tout accessoire non recommandé par Black & Decker, avec cet outil, pourrait s'avérer dangereuse.

⚠ **AVERTISSEMENT :** Le châssis de tondeuse et le taille-bordures ne sont pas des jouets. L'utilisation en tant que jouets peut avoir comme conséquence des blessures ou des dommages matériels.

⚠ **MISE EN GARDE :** Inspectez la zone à rogner et enlever toutes les pierres, bâtons, fils métalliques, cordons ou des objets filiformes qui pourrait s'emmêler dans le fil en rotation ou bobine. Relâcher l'interrupteur et laissez la tondeuse à arrêter avant de traverser à pied, les routes, le patio et les lecteurs de gravier.

#### MONTAGE

⚠ **AVERTISSEMENT :** avant de procéder aux étapes d'assemblage ou de démontage décrites ci-dessous, assurez-vous que le taille-bordure à fil rotatif est éteint et débranché du bloc d'alimentation.

⚠ **MISE EN GARDE :** Reportez-vous à votre manuel de taille-bordures à fil rotatif avant d'utiliser le taille-bordures en conjonction avec le châssis de tondeuse.

Pour fixer un taille-bordures à fil rotatif au châssis de tondeuse (1) :

- Faire glisser la partie inférieure de la tête du taille-bordure à fil rotatif (5) dans la partie avant de la poche du taille-bordures (2) et faire tourner le pare-main du taille-bordure (6) vers le bas dans la poche jusqu'à ce qu'il s'enclenche entièrement en place comme illustré

